

## High Cop Intelligent High Temperature Heat Pump For Cold Climate CE ISO

Our Product Introduction

for more products please visit us on horizontal-slurrypump.com

### Basic Information

- Place of Origin: Guangzhou China
- Brand Name: horizontal-slurrypump.com
- Certification: CE ISO CCC UKAS,ROHS
- Model Number: OEM
- Minimum Order Quantity: 5 PCS
- Price: Negotiation
- Packaging Details: Plywooden case
- Delivery Time: 15 days
- Payment Terms: T/T, L/C WESTERN UNION
- Supply Ability: 800/MONTH



### Product Specification

- Material: Galvanized Sheet
- Contactor: Fuji Brand
- Copper Thick: 1 Mm
- Compressor: With Oil Heater
- Working Temperature: -20--45 Degree
- Insulation: Foam Pack Pipe And Stick On The Machine Inner
- Display: LCD Figer Touch
- Control: Wifi Function Support
- Highlight: **high temperature air to water heat pump**

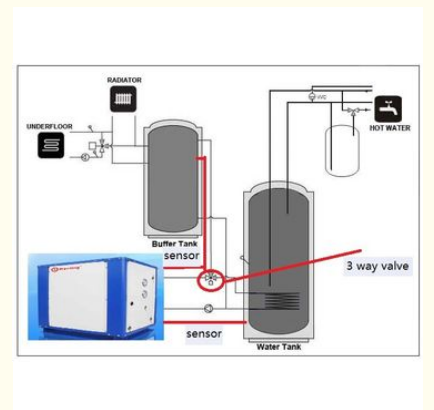

### More Images



## Product Description

Max. output hot water :80deg.C  
 Copeland ZW scroll compressor  
 Absolutely safe external control system  
 High COP

This series of air source heat pump is specially designed for the highest water temperature can reach 80 deg.C. It is adopted the most advanced high- temperature Enhanced Vapors Injection compressor technology. The heat pump performance has been improved greatly with Copeland high temperature scroll compressor from Emerson company and with Deron specially designed economizer and high efficiency heat transfer module.

1. Hot water output temperature up to 80°C.
2. COP can be up to 3.5, when A20W15/80.
3. Eco-friendly refrigerant: R134A.
4. Auto- defrosting function included (with reverse cycle valve inside).
5. Anti-corrosion case: durable coating; no-screw design with stainless steel bolts and nuts, no rust.
6. General testing and operational test carried out for every before package in the factory.
7. Comprehensive protection, --- ensures trouble free operation in extremely cold ambient. Anti-freezing protection, Water flow protection, Over high pressure protection, Over low pressure protection etc.
8. Got EN14511 test report and CE certificate

High temperature heat pump

1. HIGH EFFICIENCY & ENERGY SAVING:

Meeting Air Source Heat Pump Water Heater COP >4 , Saving 70%~80% electricity cost.(7dC Ambient Temp,35dC Output Water Temp)

2. HEAT PUMP COMPRESSOR:

Meeting Air Source Heat Pump use Famous Brand scroll ZWKSE series compressor and environmentally friendly refrigerant R407C/R410A/R417, stable working at -25dC ambient temperature.

3. HEAT PUMP EXCHANGER:

Use high efficient tank heat exchanger for heating & domestic hot water. Stainless steel plate heat exchanger for heating & cooling.

4. AUTOMATIC DEFROSTING:

Automatic defrosting and power-off memory function.

5. INTELLIGENT MICROCOMPUTER SYSTEM:

With LCD panel, can manually, automatically switch heat pump unit on/off, timer switch unit on/off, fault alarm, fault code display.

6. MULTIFUNCTIONAL SELF-PROTECTION:

Phase sequence protection, high and low pressure protection, current protection, high and low temperature protection, antifreeze protection on low temp Heat Pump.

7. ANTI FREEZE:

Add chassis electric heater to avoid condensate water freezes in winter.

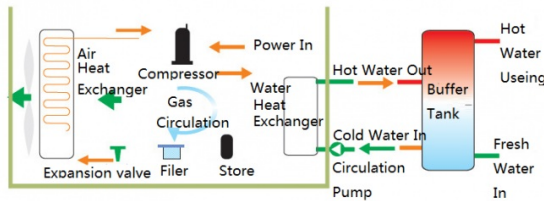

Model	Unit	MDS100D
Rated heating capacity	KW	38
Hot water supply	L/h	800
Average heating input power	KW	8.8
Rated heating input current	A	18
Max outlet water temp	°C	80
COP		4.6
Power	V/Hz	380V/50
Noise	Db(a)	55
Dimension	W*D*H	mm 1050*810*760
Packing size	W*D*H	mm 1140*900*910
Unit weight	KG	290
Refrigerant		R134A
Working air temp range	°C	(-40°C)—45°C
compressor	Type	Copeland
water source heat exchanger	Type	Plate heat exchange
	Pipe size	DN 32
Hot water side heat exchange	Type	Coil heat exchanger
	Water flow	L/H 10000L/h
	Water pressure down	Kpa 50
	Pipe size	DN 32
	Max house heating	M2 300

America Emerson Company Copeland Brand Compressor  
MD30D,MD40D,MD50D,MD60D,....All use ZW Series



America Copeland Compressor

Automatic Controller



Sanhua Four Way Valve



Sanhua Electric Expansion valve



 **ROMAN** Beijing Silk Road Enterprise Management Services Co.,LTD

 0086-17773109286

 jeffreyth@slurrypump.com

 horizontal-slurrypump.com

Floor 5, 2nd Building, Zhonglu Industrial Zone, Shenzhen City, Guangdong Province China (Mainland)