



Single Stage Circulating Centrifugal Pump , Corrosive Resistant Chemical Pump

Our Product Introduction

Basic Information

- Place of Origin: Sichuan, China
- Brand Name: horizontal-slurrypump.com
- Certification: ISO9001
- Model Number: OEM
- Minimum Order Quantity: 1 set
- Price: USD 500-5000/set
- Packaging Details: free fumigation export wooden box packaging
- Delivery Time: 25 working days after receiveing advance payment
- Payment Terms: L/C, D/A, D/P, T/T, Western Union, MoneyGram, Paypal
- Supply Ability: 300 sets per month



Product Specification

- Max Flow: 450m3/h
- Max Head: 120m
- Speed: 1450rpm-2900rpm
- Temperature: -50-80°C
- Pressure: Middle Pressure
- Warranty: 1 Year
- Structure: Single-stage Pump
- Theory: Centrifugal Pump
- Highlight: **vertical submerged centrifugal pump**



for more products please visit us on horizontal-slurrypump.com

Product Description

Single-stage Circulating Centrifugal Pump Sustainable Corrosive Resistant Chemical Pump

Application

In refineries, petrochemical industry, coal processing and low temperature engineering.
In chemical industry, fibre and general processing industries, particularly in paper and pulp industries, sugar industry.
In water industry, particularly seawater desalination plants.
In heating and air-conditioning.
In fossil and nuclear power-stations.



Fertilizer Industry



Desalination Industry



Chemical Industry



Power Plant



Mining Industry



metallurgy Industry

Product Summary

anti-abrasive and anti-corrosive vertical submerged centrifugal pump
single stage single-suction pump
excellent performance
advanced structure
strong bearing
stable operation
easy maintenance
long service life
Diameter: 200mm~470mm
Structure: single-stage pump
Capacity: 8 ~ 800 m³/h
Head: 10 ~ 90 m
Maximal Efficiency: 70%
NPSH: 1.4m~4.5m
Allowed Max Particle Size: 20 mm
RPM: 1450 r/min
Impeller Type: closed/ half open

Bearing box

WDL series corrosion-resistant and wear-resistant vertical pumps are equipped with axial adjustment devices. After the flow parts have some wear and corrosion, the gap between the impeller and the pump body can be adjusted through the hexagonal top screw on the bearing box to prolong the service life.

Bearing body

The bearing body uses a double bearing structure to bear the radial and axial forces. The WDL-series pump is equipped with a cylindrical roller bearing with radial force at the lower end. The upper end of the pump is equipped with double row angular contact ball bearings to bear the axial force and partial radial force.

Technical Parameter

model	flow (m ³ /h)	Head (m)	Rotating speed (r/min)	Highest efficiency (%)	pump head weight KG	Submerged depth mm	Shaft component
40WDL-250	8-20	15-28	1450	39	620	1300/1000	100
40WDL-310	8-40	23-42	1450	45	692	1300/1000	100
40WDL-350	8-45	35-54	1450	37	870	1300/1000	120
50WDL-250	10-30	15-28	1450	40	642	1300/1000	100
50WDL-310	15-60	25-42	1450	45	705	1300/1000	100
50WDL-350	15-70	35-54	1450	50	886	1300/1000	120
50WDL-400	20-75	50-75	1450	45	961	1300/1000	120
65WDL-250	30-70	15-28	1450	48	652	1300/1000	100
65WDL-310	30-90	25-40	1450	57	905	1300/1000	120
65WDL-350	40-100	35-54	1450	59	915	1300/1000	120

65WDL-400	50-120	45-75	1450	55	1008	1300/1000	120
65WDL-450	50-120	70-95	1450	52	1075	1300/1000	120
80WDL-250	70-100	15-25	1450	61	652	1300/1000	100
80WDL-310	70-120	25-40	1450	62	935	1300/1000	120
80WDL-350	70-160	35-52	1450	65	940	1300/1000	120
80WDL-400	70-160	50-75	1450	62	1068	1300/1000	120
80WDL-450	70-160	70-95	1450	60	1100	1300/1000	120
100WDL-310	100-150	20-38	1450	65	960	1300/1000	120
100WDL-350	100-220	35-50	1450	65	970	1300/1000	120
100WDL-400	100-220	40-72	1450	65	1125	1300/1000	120
125WDL-310	120-260	18-36	1450	67	1025	1300/1000	120
125WDL-350	120-300	35-50	1450	68	1035	1300/1000	120
125WDL-400	140-350	45-70	1450	70	1206	1300/1000	120
125WDL-450	150-360	65-90	1450	67	1497	1300/1000	140
150WDL-310	200-400	18-35	1450	72	1127	1300/1000	120
150WDL-350	200-450	25-48	1450	75	1175	1300/1000	120
150WDL-400	200-450	40-65	1450	73	1668	1300/1000	140

Product Picture



Main Usage

◆ chemical plants, power stations
◆ iron and steel metallurgy enterprises
◆ paper mills
◆ petrochemical refineries
◆ chemical factories
◆ construction of thermal power plants and power stations
◆ textile mills, sugar factories
◆ mines

Installation Dimension

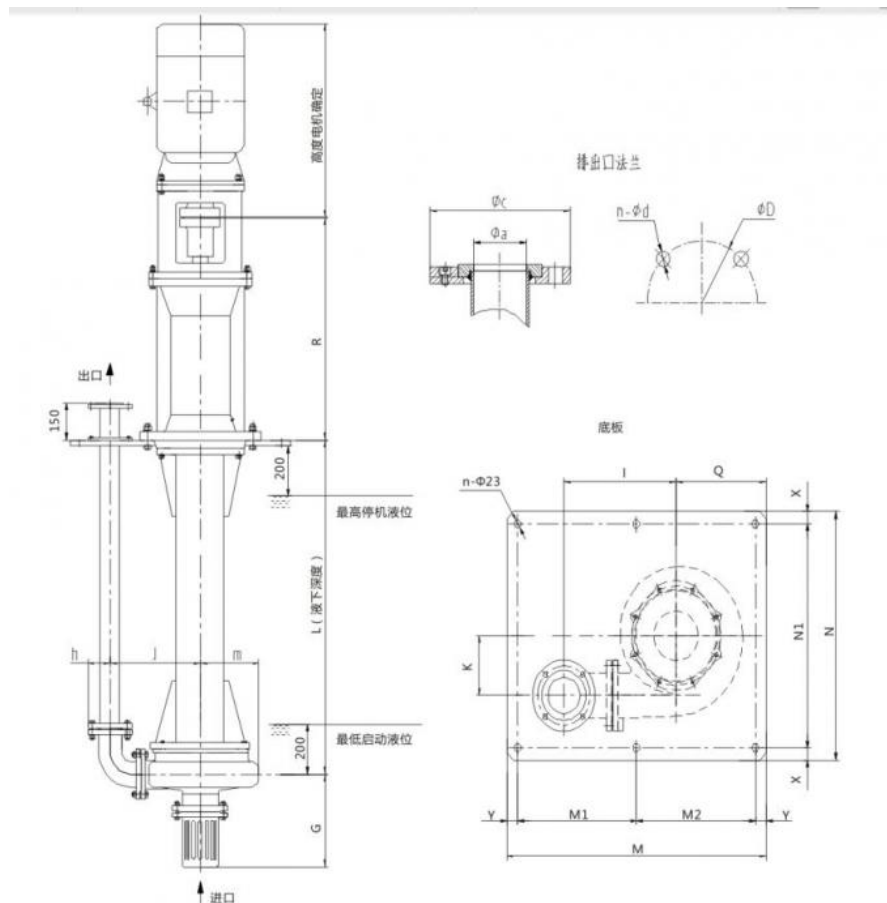

FAQ

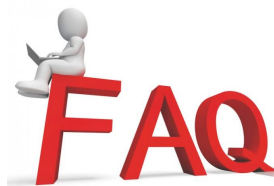

1. Q: Are you a manufacturer or trading company?

A: We are a manufacturer established in 2000, professional manufacturer of chemical-process pump and energy-saving mixer with more than 20-year experience.

2. Q: What's your delivery time?

A: The batch order will be shipped within 40 working days after receiving deposit.

3. Q: What's your warranty service policy?

A: 12 Months for all products, and some products warranty is 24months.

4. Q: What information I need to offer for quotation?

A: Medium: _____ PH: _____
 Specific Gravity: _____ Temperature: _____
 Capacity/Flow: _____ m³/h Head: _____ m
 Voltage: _____ V Frequency: _____ Hz
 Power: _____ KW

5. Q: What is your minimum quantity?

A: One set is also welcomed to us.

 **ROMAN** Beijing Silk Road Enterprise Management Services Co.,LTD

 0086-17773109286

 jeffreth@slurrypump.com

 horizontal-slurrypump.com

Floor 5, 2nd Building, Zhonglu Industrial Zone, Shenzhen City, Guangdong Province China (Mainland)